



1, 2 & 3BHK ULTRA LUXURY APARTMENTS  
@ KIADB, AEROSPACE PARK, BAGALUR, BANGALORE



SITE ADDRESS:  
Plot No R-9-B, Hitech Defence Aerospace  
Park (Hardware Sector),  
Opposite Brigade El Dorado Gummanahalli  
North Bangalore - 562149.

CONTACT:  
**903 698 5176 | 974 070 9787 | 900 831 6004**

RERA NO: PRM/KA/RERA/1251/472/PR/091024/007138



**RETURN TO A PLACE OF JOY**

RERA NO: PRM/KA/RERA/1251/472/PR/091024/007138



**WE DESIGN SPACES THAT BRING  
EVERYDAY HAPPINESS, FOSTERING A  
SENSE OF COMMUNITY, UNITY, AND  
BELONGING IN EVERY HOME.**



Let's cherish the  
little moments of Every day  
Joys right at home

**WELCOME TO**



1, 2 & 3BHK ULTRA LUXURY APARTMENTS  
@ KIADB, AEROSPACE PARK, BAGALUR, BANGALORE

**A HOME DESIGNED FOR YOUR  
WELL-BEING,  
WHERE EVERY DAY BEGINS AND ENDS  
WITH HAPPINESS**



An architectural rendering of the NVG Rakshak building at dusk. The building is a multi-story structure with a modern design, featuring a mix of white, brown, and blue tones. The ground floor is a glass-fronted commercial space with multiple levels of retail units, some of which are illuminated from within. The upper floors are residential, with balconies and large windows. The building is set against a vibrant sky with shades of pink, orange, and purple. In the foreground, there is a wide road with a few pedestrians and a car. A small entrance gate with the building's name is visible on the right side of the road.

Discover NVG Rakshak, a landmark of luxury in Bangalore, offering a perfect balance of modern architecture and timeless elegance. Designed for discerning homeowners, NVG Rakshak is more than just a residence—it's a statement of prestige and comfort, crafted to meet the highest standards of luxury living.

ELEVATE YOUR LIFESTYLE,  
EXPERIENCE LUXURY



# MASTER PLAN



## LEGEND

- ENTRY /SECURITY CABIN
- 2. FLORAL GARDEN
- 3. PARKING GARDEN
- 4. EXIT /SECURITY CABIN
- 5. FAVILION LEISURE
- 6. ENTRY LAWN
- 7. BICYCLE STAND
- 8. WIDE DRIVEWAY
- 9. FLORAL GARDEN
- 10. INFORMAL SEATING
- 11. SAND PLAY
- 12. TOT LOT
- 13. HOP SKOTCH
- 14. DRIBBLE COURT
- 15. YOUTH CORNER
- 16. FRUIT ORCHIDS
- 17. PLAY EQUIPMENTS
- 18. ELDERS ZONE WITH GYM EQUIPMENT
- 19. AROMA GARDEN
- 20. CHIT CHAT CORNER
- 21. HERBAL GARDEN
- 22. CRICKET PITCH
- 23. PETS CORNER
- 24. PEBBLE GARDEN
- 25. BUTTERFLY GARDEN
- 26. MULTIPURPOSE HALL
- 27. POOL DECK
- 28. SWIMMING POOL
- 29. TODDLERS POOL
- 30. GYM
- 31. INDOOR GAMES
- 32. WAITING LOUNGE
- 33. COMMERCIAL SPACE





UNIT PLANS

Vastu Compliant unit plans thoughtfully designed to ensure maximum indoor and outdoor spaces.

3 BHK-  
1045 TO 1550 SFT

| TYPE | CARPET AREA | SUPER BUILTUP AREA |
|------|-------------|--------------------|
| 3BHK | 786 SFT     | 1045 SFT           |
| 3BHK | 789 SFT     | 1050 SFT           |
| 3BHK | 929 SFT     | 1235 SFT           |
| 3BHK | 978 SFT     | 1300 SFT           |
| 3BHK | 1052 SFT    | 1400 SFT           |
| 3BHK | 1057 SFT    | 1405 SFT           |
| 3BHK | 1162 SFT    | 1545 SFT           |
| 3BHK | 1166 SFT    | 1550 SFT           |

3BHK  
WEST

|                    |          |
|--------------------|----------|
| UNIT NO            | 09, 22   |
| CARPET AREA        | 786 SFT  |
| SUPER BUILTUP AREA | 1045 SFT |



3BHK  
NORTH

|                    |          |
|--------------------|----------|
| UNIT NO            | 10, 11   |
| CARPET AREA        | 789 SFT  |
| SUPER BUILTUP AREA | 1050 SFT |





## 3BHK WEST

|                    |          |
|--------------------|----------|
| UNIT NO            | 23       |
| CARPET AREA        | 929 SFT  |
| SUPER BUILTUP AREA | 1235 SFT |



## 3BHK EAST

|                    |          |
|--------------------|----------|
| UNIT NO            | 25       |
| CARPET AREA        | 929 SFT  |
| SUPER BUILTUP AREA | 1235 SFT |



## 3BHK EAST

|                    |          |
|--------------------|----------|
| UNIT NO            | 26       |
| CARPET AREA        | 929 SFT  |
| SUPER BUILTUP AREA | 1235 SFT |



## 3BHK WEST

|                    |          |
|--------------------|----------|
| UNIT NO            | 24       |
| CARPET AREA        | 929 SFT  |
| SUPER BUILTUP AREA | 1235 SFT |







## 3BHK WEST

|                    |          |
|--------------------|----------|
| UNIT NO            | 05       |
| CARPET AREA        | 978 SFT  |
| SUPER BUILTUP AREA | 1300 SFT |



## 3BHK EAST

|                    |          |
|--------------------|----------|
| UNIT NO            | 07       |
| CARPET AREA        | 978 SFT  |
| SUPER BUILTUP AREA | 1300 SFT |



## 3BHK EAST

|                    |          |
|--------------------|----------|
| UNIT NO            | 08       |
| CARPET AREA        | 978 SFT  |
| SUPER BUILTUP AREA | 1300 SFT |



## 3BHK WEST

|                    |          |
|--------------------|----------|
| UNIT NO            | 06       |
| CARPET AREA        | 978 SFT  |
| SUPER BUILTUP AREA | 1300 SFT |







## 3BHK WEST

|                    |          |
|--------------------|----------|
| UNIT NO            | 27       |
| CARPET AREA        | 1057 SFT |
| SUPER BUILTUP AREA | 1405 SFT |



## 3BHK EAST

|                    |          |
|--------------------|----------|
| UNIT NO            | 29       |
| CARPET AREA        | 1052 SFT |
| SUPER BUILTUP AREA | 1400 SFT |



## 3BHK EAST

|                    |          |
|--------------------|----------|
| UNIT NO            | 30       |
| CARPET AREA        | 1057 SFT |
| SUPER BUILTUP AREA | 1405 SFT |



## 3BHK WEST

|                    |          |
|--------------------|----------|
| UNIT NO            | 28       |
| CARPET AREA        | 1052 SFT |
| SUPER BUILTUP AREA | 1400 SFT |







## 3BHK WEST

|                    |          |
|--------------------|----------|
| UNIT NO            | 01       |
| CARPET AREA        | 1166 SFT |
| SUPER BUILTUP AREA | 1550 SFT |



## 3BHK EAST

|                    |          |
|--------------------|----------|
| UNIT NO            | 03       |
| CARPET AREA        | 1162 SFT |
| SUPER BUILTUP AREA | 1545 SFT |

## 3BHK EAST



|                    |          |
|--------------------|----------|
| UNIT NO            | 04       |
| CARPET AREA        | 1166 SFT |
| SUPER BUILTUP AREA | 1550 SFT |

## 3BHK WEST



|                    |          |
|--------------------|----------|
| UNIT NO            | 02       |
| CARPET AREA        | 1162 SFT |
| SUPER BUILTUP AREA | 1545 SFT |





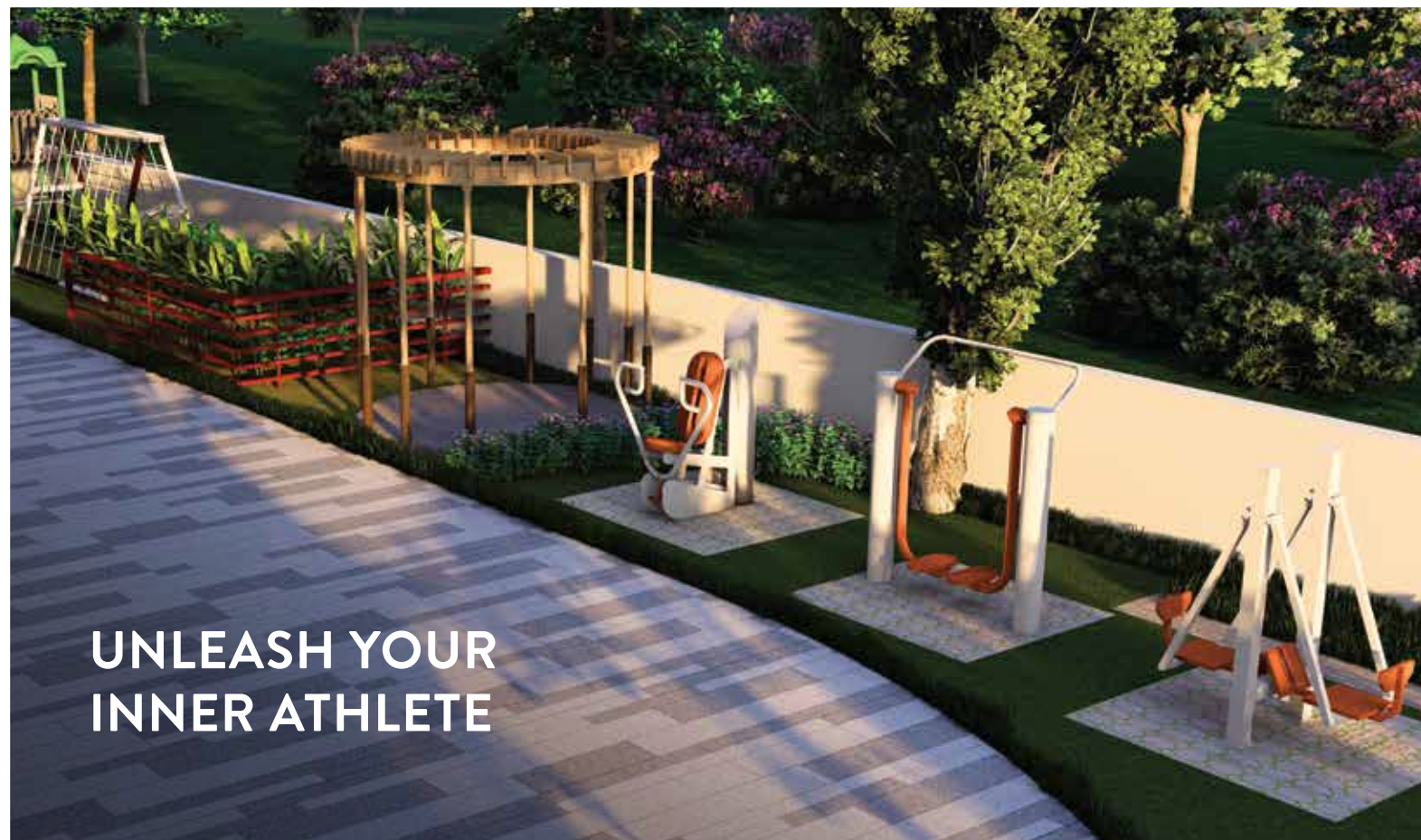

UNLEASH YOUR  
INNER ATHLETE

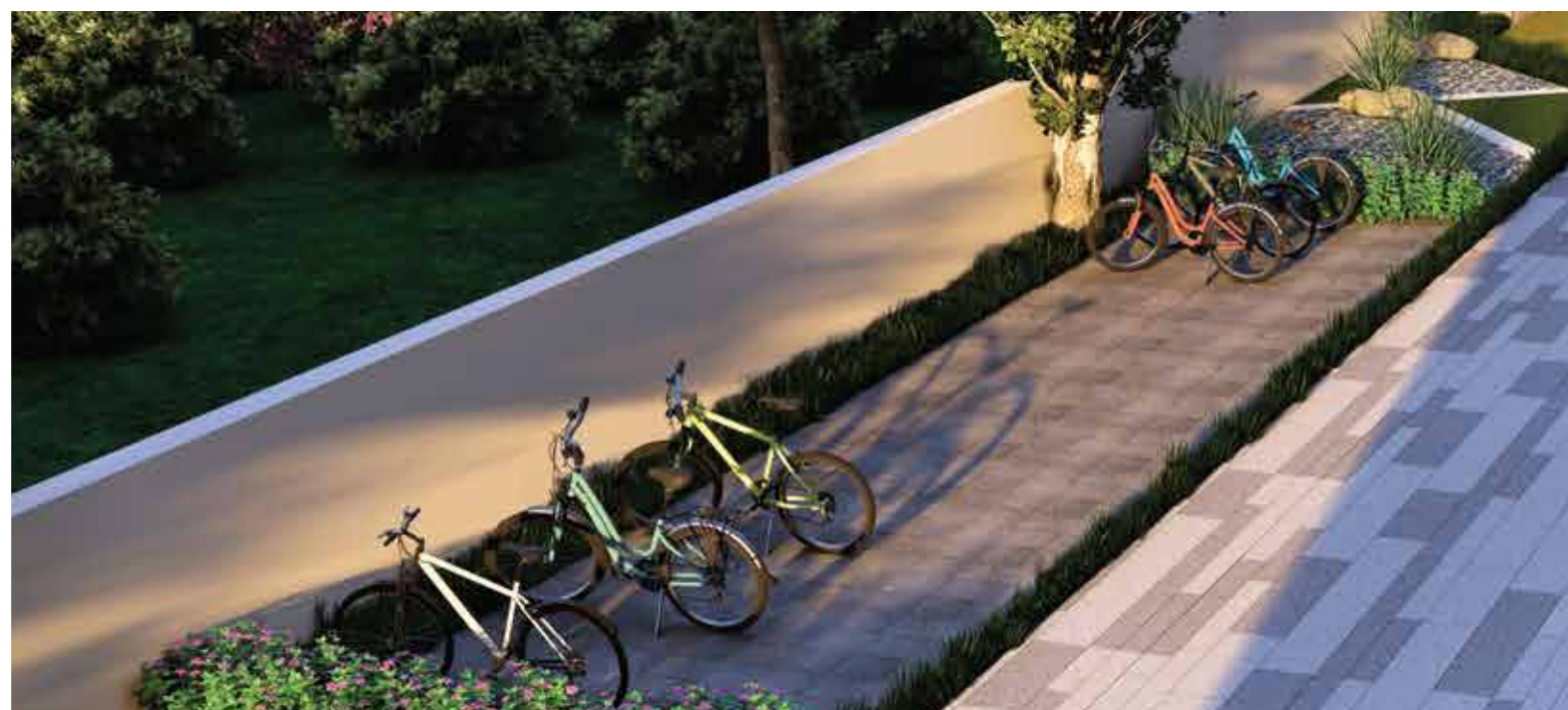

## REDEFINING URBAN LUXURY IN BANGALORE



At NVG Rakshak, luxury is woven into every detail. From the grand entrance to the expansive living spaces, every aspect of these premium apartments has been meticulously planned to provide an unmatched living experience.



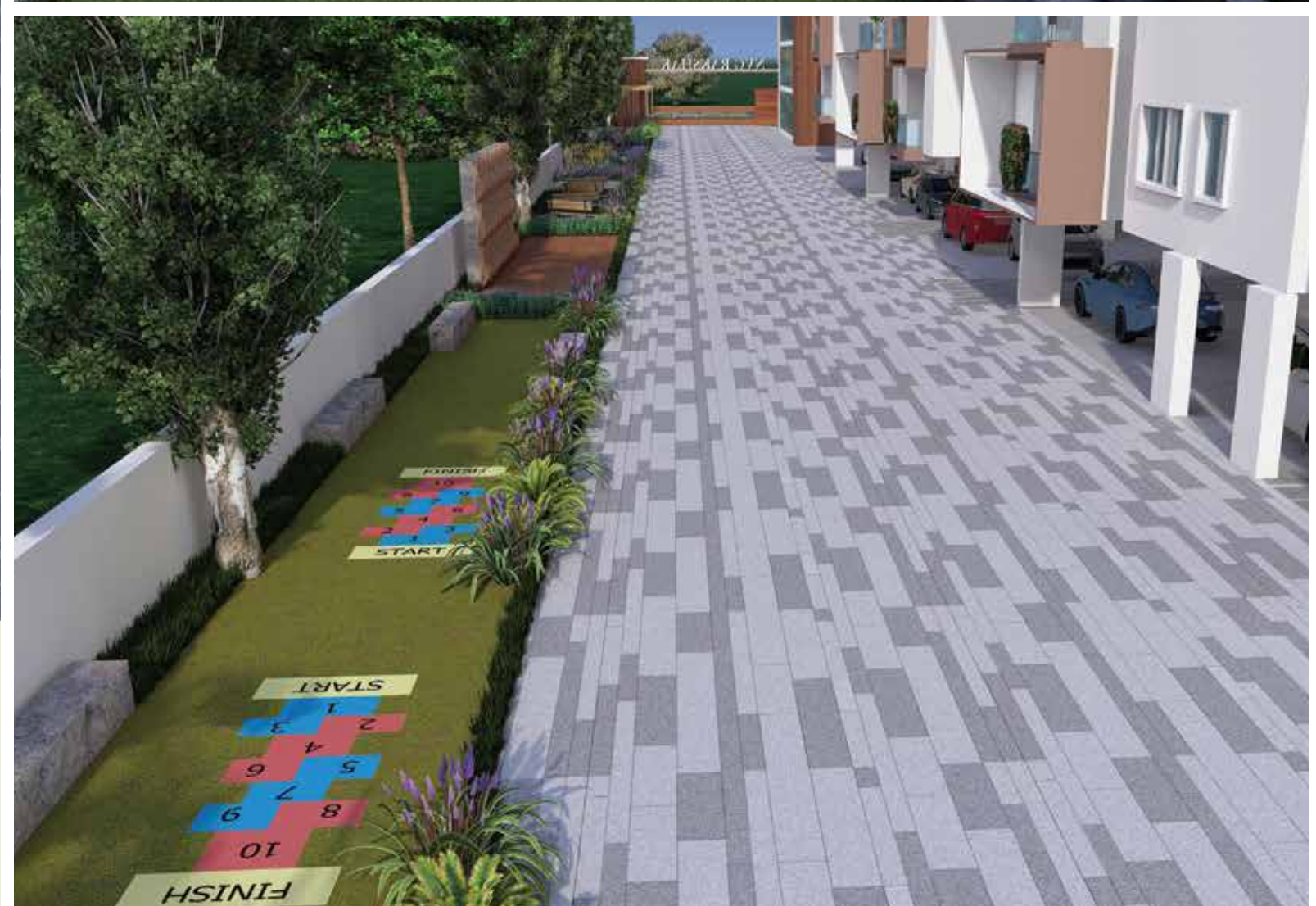
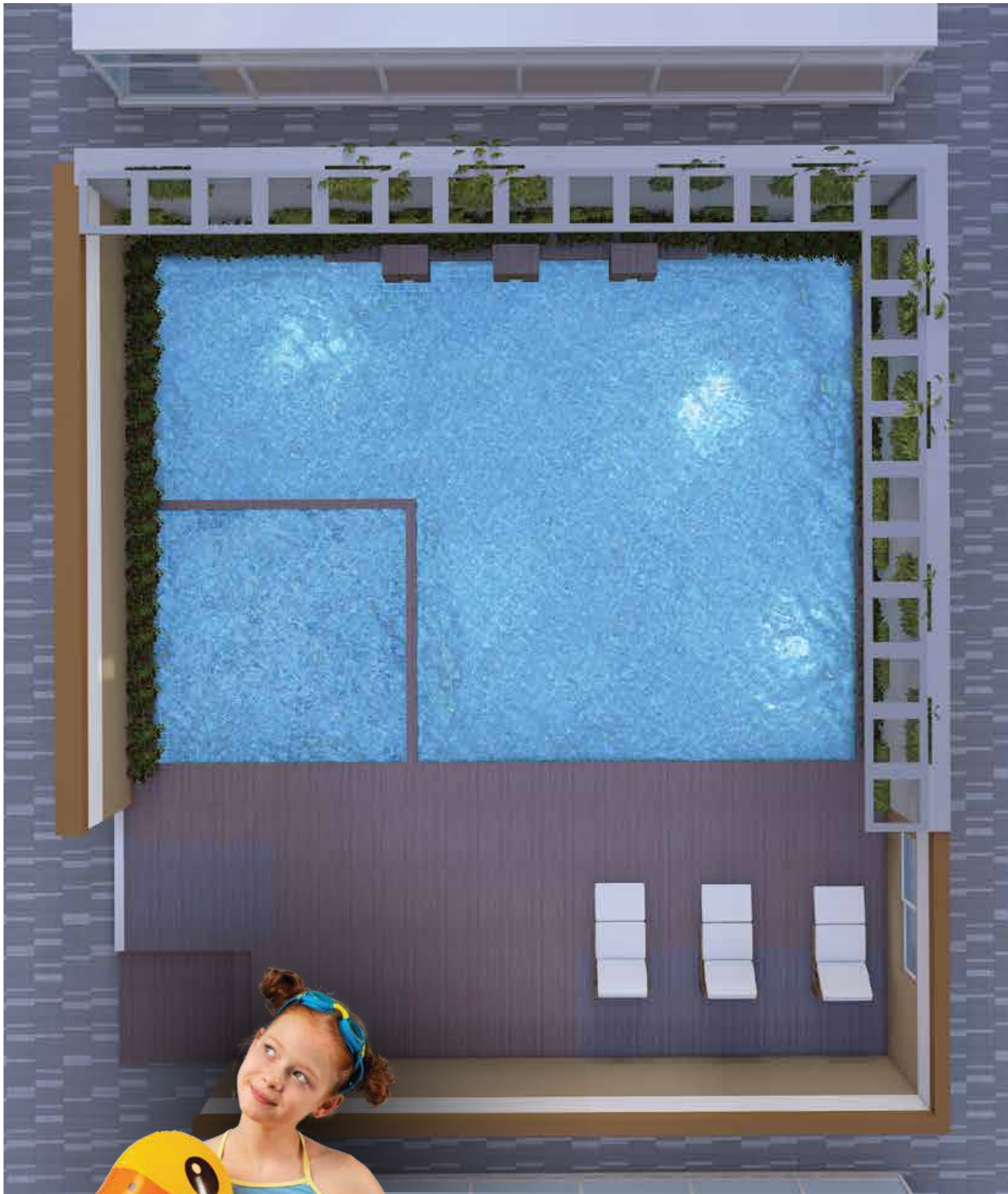

**DIVE INTO LUXURY,  
EVERY DAY**



# SPECIFICATIONS

## STRUCTURE:

RCC Steel framed structure

## COMMON AREA – FLOORING:

- Staircase; Concrete step tile / Granite / Vitrified tiles (cera / kajaria/ somany / orient or equivalent).
- Other lift lobby and corridors; Granite / Vitrified tiles (cera / kajaria / somany / orient or equivalent).

## APARTMENT UNITS – FLOORING:

Living area, Dining, Bedrooms & Kitchen; Vitrified tiles (cera / kajaria / somany / orient or equivalent).

**Balcony Area;** Anti-skid Vitrified tiles (cera / kajaria / somany / orient or equivalent).

**Toilets;** Anti-skid Vitrified tiles (cera / kajaria/ somany / orient / equivalent).

## WALL DADDO:

Toilet walls; Vitrified tiles upto beam level (cera / kajaria / somany/ orient or equivalent).

## KITCHEN:

Counter Slab; 30mm Granite and 2feet wall dado above the kitchen granite slab level.

## PLUMBING AND ELECTRICAL:

- Plumbing point provision for water purifier, washing machine.
- Electrical point provision for water purifier, refrigerator, hob, chimney, mixer / grinder, microwave oven and washing machine.

## SECURITY SYSTEM AND AUTOMATIONS:

Provision for Intercom facility and CCTV as per Design.

## SUSTAINABILITY:

Ground water recharging, Rainwater storage, Street light and STP.

## DG BACKUP:

- 3Bedroom Apartments ;0.75KW
- 2Bedroom Apatments ; 0.50KW

## VERTICAL TRANSPORTATION:

Lifts; OTIS / JOHNSON / KONE / SCHIENDLER.

## WINDOWS:

UPVC

## DOORS:

**Door Frame** - Teak wood or Equivalent.

**Door Shutters** - Flush shutter with both side laminate and architrave.

- Bedroom Shutters - Particle board with half skin and architrave.

- Toilet Shutters - Shutter laminated both side laminate and architrave.

- Balcony Door – UPVC.

## WIRING AND SWITCH SOCKETS:

- Wire materials; Havells / Anchor / Polycab / Finolex with Tested specifications as per IS- Standards.
- Switch sockets; Havells / Anchor / Cona or Equivalent.

## PLUMBING:

CPVC and PVC; Ashirvad / Astral/ Prince / Supreme / Apoorva.

## TOILETS:

CP and Sanitary Fittings; Floor mounted White EWC (Hindware / Parryware / Cera or Equivalent).

## PAINTING AND FINISHING:

- Accessories; Combination of external texture paint with external grade emulsion.
- Internal ceiling and common area; Oil bound distemper or emulsion.
- Internal wall, common area and lift lobby; Emulsion paint.
- Staircase, Utility area and service area; Oil bound distemper.
- Unit walls; Acrylic emulsion paint.
- Steel works; Synthetic enamel paint.
- Wood works; Enamel paint.

## ELECTRICALS:

- 3Bedroom Apartments ; 3KW
- 2Bedroom Apatments ; 2KW



# LOCATION

## Nearby Landmarks

### Tech Parks / Work Spaces

- Wipro Aerospace
- Manyata Tech Park
- Karle Town Centre SEZ
- L&T Tech Park
- Kirloskar Business Park
- Shell Technology Centre
- Boeing
- Foxconn
- Thyssenkrupp
- Financial City
- Brigade Magnum

### Schools and Colleges

- Reva University
- CRM University
- Delhi Public School
- National Public School
- Greenfield Int School
- Canadian Int School
- Chrysalis School
- Presidency College
- Presidency University
- Presidency School

### Hospitals

- Aster Hospital
  - Columbia Asia
  - Regal Hospital
- ### Shopping / Malls
- Mall of Asia
  - Esteem Mall
  - Elements Mall
  - Bhartiya Mall
  - Galleria Mall
  - Lulu Value Mart

### Others

- Bangalore International Airport
- Byg Brewski
- Decathlon
- Hebbal Flyover